



Sistema 2000 serie 25 

## Geometria e Filettature Serie 25

La Serie 25 è progettata su una dimensione di base 25 x 25 mm. Le scanalature a T di 6 mm sono distanziate 25 mm. Le filettature possono essere ricavate nei fori esistenti.

 Vedi lavorazioni per profilo a pagina 64

Le estremità del Profilo possono essere direttamente maschiate.

 P. 214

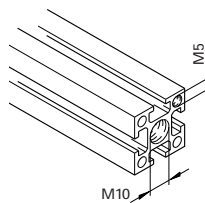
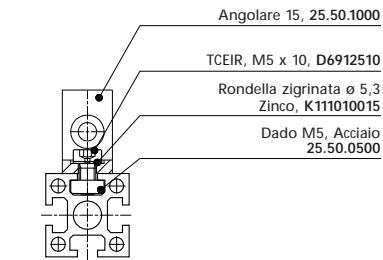

Lunghezza consigliata della vite =  $2 \cdot d_N$

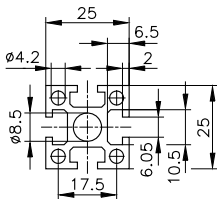

Altre filettature sono possibili con inserti.

 P. 71

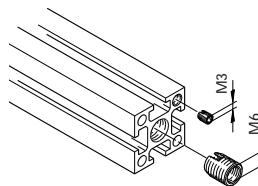
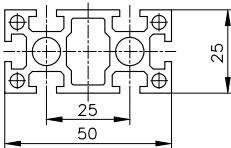

Inserto filettato M3  
K112030002

Inserto filettato M6  
K112030006

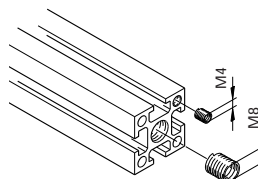
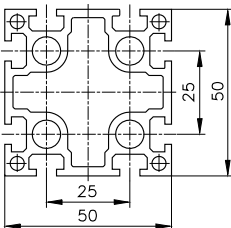

Helicoil M4  
K112030104

Helicoil M8  
K112030109



Sistema 2000 serie 25 

## Serie 25

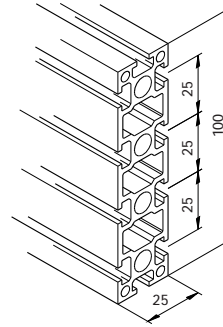

### Profilo mk 2025.03

2,55 kg/m

AlMgSi 0,5 F25

Lung. stock **25.03.5100**

A misura **25.03. ....\***

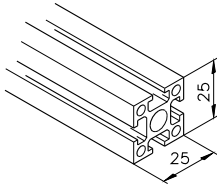

### Profilo mk 2025.01

0,75 kg/m

AlMgSi 0,5 F25

Lung. stock **25.01.5100**

A misura **25.01. ....\***

Lavorazioni da pagina 64

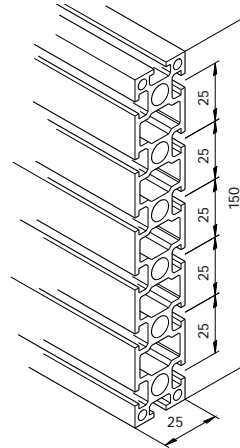

### Profilo mk 2025.04

3,75 kg/m

AlMgSi 0,5 F25

Lung. stock **25.04.5100**

A misura **25.04. ....\***

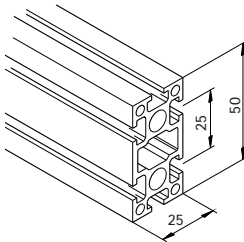

### Profilo mk 2025.02

1,35 kg/m

AlMgSi 0,5 F25

Lung. stock **25.02.5100**

A misura **25.02. ....\***

Lavorazioni da pagina 64

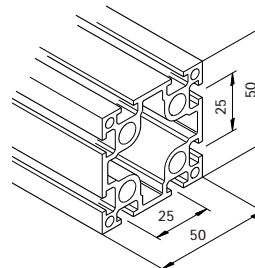

### Profilo mk 2025.05

2,21 kg/m

AlMgSi 0,5 F25

Lung. stock **25.05.5100**

A misura **25.05. ....\***

Lavorazioni da pagina 64

# Profili strutturali

Sistema 2000 serie 25 

## Serie 25 con scanalature a T ristrette

Oltre al sistema standard di scanalatura a T, i Profili della Serie 25 con scanalature a T ristrette, hanno una seconda scanalatura più piccola in cui può essere inserita un pannellatura. Questo pannellatura può essere incassata o rielaborata in modo da essere livellata con l'intelaiatura.

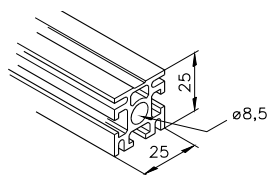
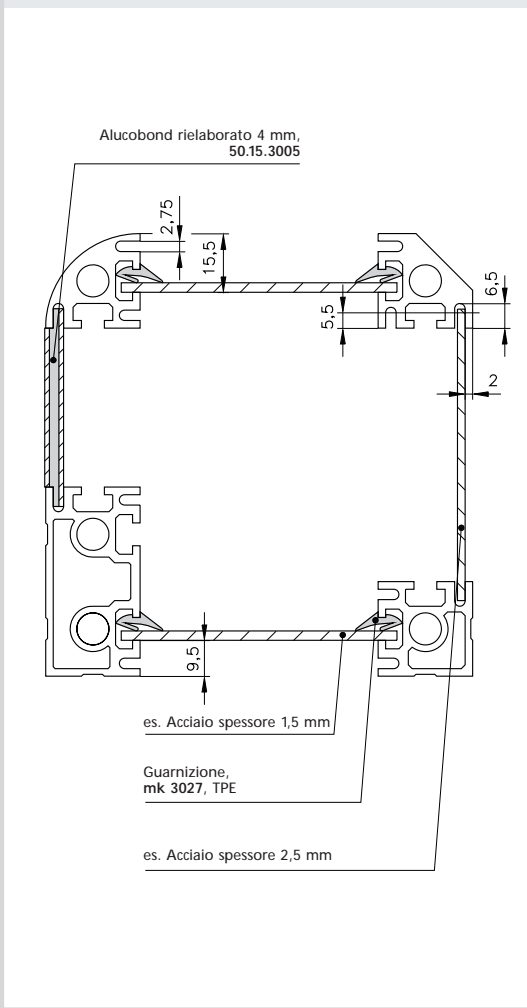
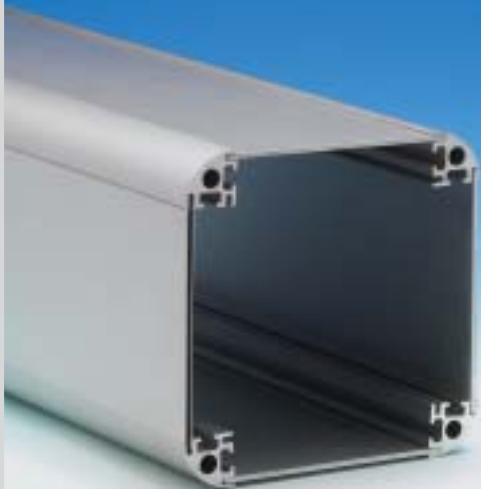

**Profilo mk 2025.31**

0,77 kg/m  
AlMgSi 0,5 F25

Lung. stock **25.31.5100**

A misura **25.31. ....\***

Lavorazioni da pagina 64

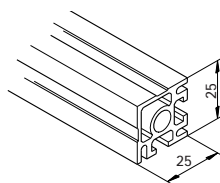

**Profilo mk 2025.35**

0,75 kg/m  
AlMgSi 0,5 F25

Lung. stock **25.35.5100**

A misura **25.35. ....\***

Lavorazioni da pagina 64

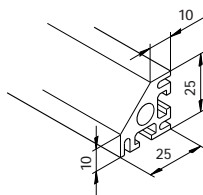

**Profilo mk 2025.38**

0,79 kg/m  
AlMgSi 0,5 F25

Lung. stock **25.38.5100**

A misura **25.38. ....\***

Lavorazioni da pagina 64

Sistema 2000 serie 25 

## Serie 25 con scanalature a T ristrette

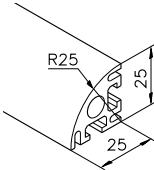

**Profilo mk 2025.37**

0,73 kg/m  
 AlMgSi 0,5 F25

Lung. stock **25.37.5100**

A misura **25.37. ....\***

Lavorazioni da pagina 64

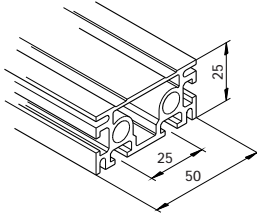

**Profilo mk 2025.32**

1,29 kg/m  
 AlMgSi 0,5 F25

Lung. stock **25.32.5100**

A misura **25.32. ....\***

Lavorazioni da pagina 64

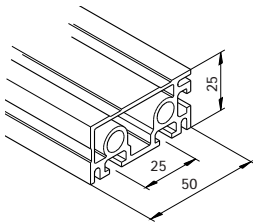

**Profilo mk 2025.36**

1,25 kg/m  
 AlMgSi 0,5 F25

Lung. stock **25.36.5100**

A misura **25.36. ....\***

Lavorazioni da pagina 64

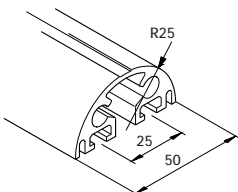

**Profilo mk 2025.39**

1,1 kg/m  
 AlMgSi 0,5 F25

Lung. stock **25.39.5100**

A misura **25.39. ....\***

Lavorazioni da pagina 64

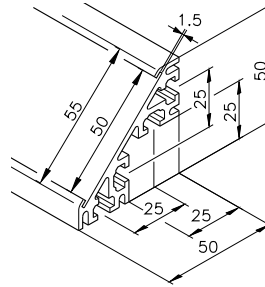

**Profilo mk 2025.25**

1,30 kg/m  
 AlMgSi 0,5 F25

Lung. stock **25.25.5100**

A misura **25.25. ....\***

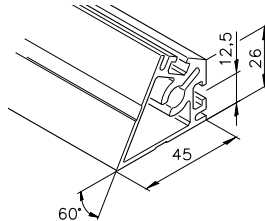

**Profilo mk 2025.16**

1,13 kg/m  
 AlMgSi 0,5 F25

Lung. stock **25.16.5100**

A misura **25.16. ....\***

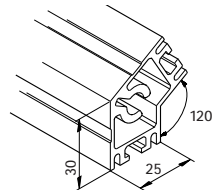

**Profilo mk 2025.17**

1,24 kg/m  
 AlMgSi 0,5 F25

Lung. stock **25.17.5100**

A misura **25.17. ....\***

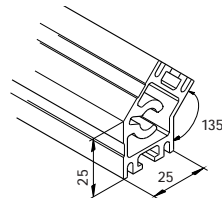

**Profilo mk 2025.18**

1,02 kg/m  
 AlMgSi 0,5 F25

Lung. stock **25.18.5100**

A misura **25.18. ....\***

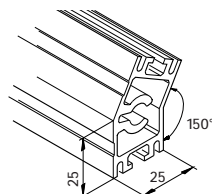

**Profilo mk 2025.19**

1,23 kg/m  
 AlMgSi 0,5 F25

Lung. stock **25.19.5100**

A misura **25.19. ....\***

# Profili strutturali

Sistema 2000 serie 25 

## Serie 25

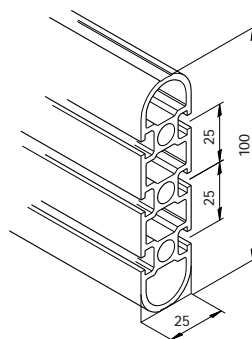

**Profilo mk 2025.22**

2,26 kg/m  
AlMgSi 0,5 F25

Lung. stock **25.22.5100**

A misura **25.22. ....\***

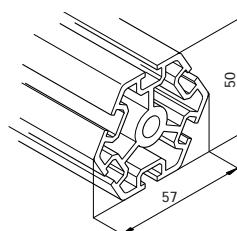

**Profilo mk 2025.20**

2,12 kg/m  
AlMgSi 0,5 F25

Lung. stock **25.20.5100**

A misura **25.20. ....\***

Lavorazioni da pagina 64

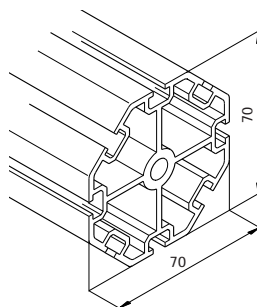

**Profilo mk 2025.21**

2,98 kg/m  
AlMgSi 0,5 F25

Lung. stock **25.21.5100**

A misura **25.21. ....\***

Lavorazioni da pagina 64

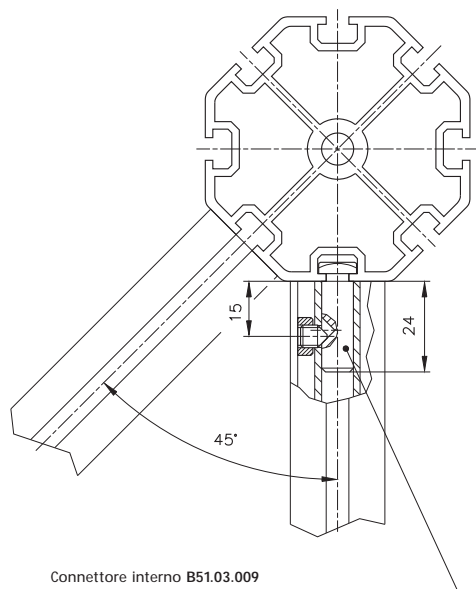

Connettore interno B51.03.009

 P. 98



Sistema 2000 serie 25 

## Profili di raccordo dalla serie 25 alla serie 40

Un lato del Profilo ha scanalature a T serie 25; l'altro lato del profilo ha scanalature a T serie 40. Ciò permette di combinare elementi della serie 25 e della 40. Le applicazioni includono:

- Collocazione di porte vetrate serie 25 all'interno di intelaiature più larghe.
- Collocazione di sostegni per impianti pneumatici.

Inserto filettato M8  
K112030008

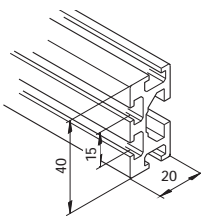
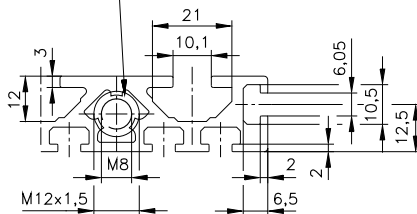

### Profilo mk 2025.41

1,02 kg/m  
AlMgSi 0,5 F25

Lung. stock **25.41.5100**

A misura **25.41. ....\***

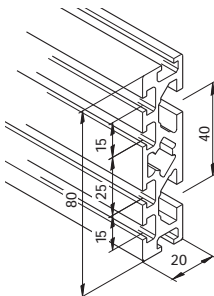

### Profilo mk 2025.42

1,94 kg/m  
AlMgSi 0,5 F25

Lung. stock **25.42.5100**

A misura **25.42. ....\***

Lavorazioni da pagina 64

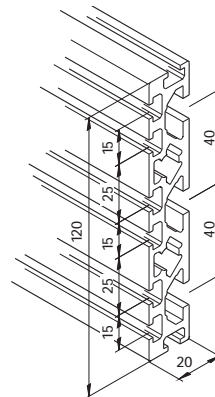

### Profilo mk 2025.43

2,86 kg/m  
AlMgSi 0,5 F25

Lung. stock **25.43.5100**

A misura **25.43. ....\***

Lavorazioni da pagina 64

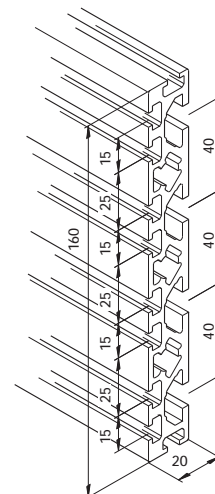

### Profilo mk 2025.44

3,77 kg/m  
AlMgSi 0,5 F25

Lung. stock **25.44.6200**

A misura **25.44. ....\***

Lavorazioni da pagina 64

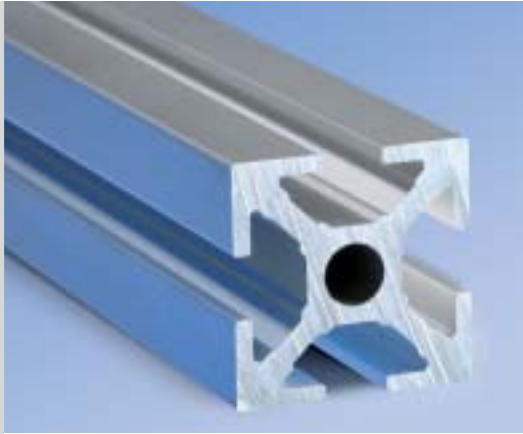

Sistema 2000 serie 40 

## Geometria e Filettature Serie 40

La Serie 40 è progettata su una base 40 X 40 mm. Le scanalature a T di 10mm sono distanziate di 40mm. Le filettature possono essere ricavate nei fori esistenti.

 Vedi lavorazioni per profilo a pagina 64

Le estremità del Profilo possono essere direttamente maschiate.

 P. 214

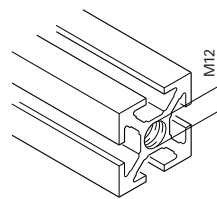
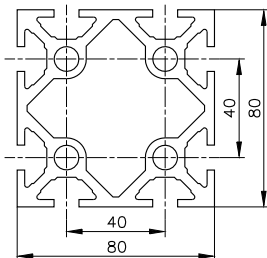
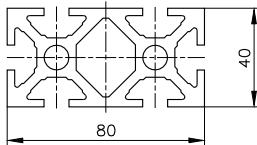
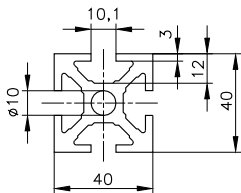
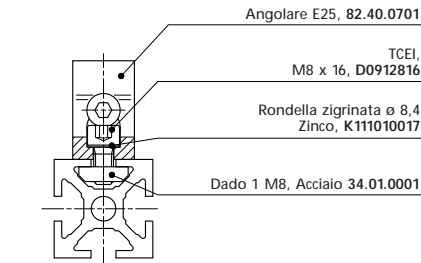

Lunghezza consigliata della vite = 2 · d<sub>N</sub>

Altre filettature sono possibili con inserti.

 P. 71

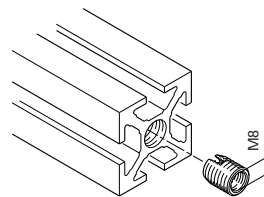

Inserto filettato M8  
K112030008

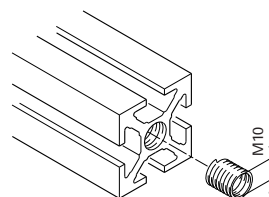

Helicoil M10  
K112030110

d<sub>N</sub> = diametro filettatura